

# SLIDE Series

ARCHITECTURAL AREA LUMINAIRE

## FEATURES

- Versatile, transitional designed lighting fixture, created to yield the ultimate in flexibility in LED Post Top Lighting
- Classic geometric form of a cylinder offers 3 different top shades, 3 LED wattages, and 5 different full cutoff lighting distributions
- Integral LifeShield thermal regulator insures maximum life and energy efficiency
- Available with a no glare LED indirect system, for use in low mounting height pedestrian walkway lighting applications



\*3000K and warmer CCTs only



## RELATED PRODUCTS

[Cruzer](#)

[SETI](#)

## CONTROL TECHNOLOGY



## SPECIFICATIONS

### CONSTRUCTION

- One piece optical cartridge system consisting of an LED engine, LED lamps, optics, gasket and stainless steel bezel
- Cartridge is held together with internal brass standoffs soldered to the board so that it can be field replaced as a one piece optical system
- Two-piece silicone and micro-cellular polyurethane foam gasket ensures a weather-proof seal around each individual LED
- Beacote V polyester powder-coat electrostatically applied and thermocured
- Beacote V finish consists of a five stage pretreatment regimen with a polymer primer sealer and top coated with a thermoset super TGIC polyester powder coat finish
- The finish meets the AAMA 605.2 performance specification which includes passing a 3000 hour salt spray test for corrosion resistance and resists cracking or loss of adhesion per ASTM D522 and resists surface impacts of up to 160 inch-pounds

### OPTICS

- 100V through 277V, 347V or 480V input, 50 Hz to 60 Hz (UNV)
- Power factor is .92 at full load
- All electrical components are rated at 50,000 hours at full load and 25°C ambient conditions per MIL- 217F Notice 2

### OPTICS (CONTINUED)

- Dimming drivers are standard with connections for external dimming equipment available upon request
- Component-to-component wiring within the luminaire may carry no more than 80% of rated load and is listed by UL for use at 600VAC at 50°C or higher
- Plug disconnects are listed by UL for use at 600 VAC, 13A or higher. 13A rating applies to primary (AC) side only

### ELECTRICAL

- The electrical chamber/fitter shall be an aluminum, decorative fitter designed to accommodate the driver assembly and shall mount to 3" OD x 4" H tenon and be secured by three stainless steel set screws
- The housing is designed for an optional twist lock photo control receptacle
- Ambient operating temperature -40°C to 40°C
- Surge protection -20KA
- Thermal circuit is designed to "fail on", allowing the luminaire to revert to full power in the event of an interruption of its power supply, or faulty wiring connection to the drivers. The device is able to co-exist with other 0-10V control devices (occupancy sensors, external dimmers, etc.)

### CERTIFICATIONS

- Listed to UL1598 and CSA22.2 #250.0-24 for wet locations and 40°C ambient temperatures
- IDA approved
- EPA 1.2

### WARRANTY

- 5 year warranty
- See [HLI Standard Warranty](#) for additional information

| KEY DATA              |              |
|-----------------------|--------------|
| Lumen Range           | 2,451-10,933 |
| Wattage Range         | 27-110       |
| Efficacy Range (LPW)  | 82-97        |
| Reported Life (Hours) | L70>640,000  |
| Weight lbs. (kg)      | 31 (14.1)    |

# SLIDE Series

ARCHITECTURAL AREA LUMINAIRE

DATE: \_\_\_\_\_ LOCATION: \_\_\_\_\_

TYPE: \_\_\_\_\_ PROJECT: \_\_\_\_\_

CATALOG #: \_\_\_\_\_

## ORDERING GUIDE

**Example:** SLD-36L-80-5K7-4-UNV-CTS-BLT

 CATALOG # 

| SLD           | Engine Watts   | LED Color   | Optics   | UNV                 | Electrical Options   | Control Options  |
|---------------|--|---|--|---------------------|--|--|
| <b>Series</b> |  |   |  | <b>Voltage</b>      |  |  |
| SLD SLIDE     | <b>24L-27</b> 27W, LED array<br><b>24L-55</b> 55W, LED array<br><b>36L-80</b> 80W, LED array<br><b>48L-110</b> 110W, LED array | <b>3K</b> 3000K, 70 CRI<br><b>4K</b> 4000K, 70 CRI<br><b>5K</b> 5000K, 70 CRI | <b>T2</b> Type II<br><b>T3</b> Type III<br><b>T4</b> Type IV<br><b>T5R</b> Type V, rectangular<br><b>T5QM</b> Type V, square medium<br><b>T5W</b> Type V, round wide | <b>UNV</b> 120-277V | <b>PEC</b> Photocell. button<br><b>2PF</b> Dual power feed | <b>SWP</b> SiteSync <sup>2,3</sup><br><b>GENI-XX</b> Energeni <sup>1</sup> |

| Shade Options           | Color                                 |
|-------------------------|---------------------------------------|
| <b>CTS</b> Curved Shade | <b>BLT</b> Black Matte Textured       |
| <b>STS</b> Sloped shade | <b>BLS</b> Black Gloss Smooth         |
| <b>FTS</b> Flat shade   | <b>DBT</b> Dark Bronze Matte Textured |
|                         | <b>DBS</b> Dark Bronze Gloss Smooth   |
|                         | <b>GTT</b> Graphite Matte Textured    |
|                         | <b>LGS</b> Light Grey Gloss Smooth    |
|                         | <b>PSS</b> Platinum Silver Smooth     |
|                         | <b>WHT</b> White Matte Textured       |
|                         | <b>WHS</b> White Gloss Smooth         |
|                         | <b>VGT</b> Verde Green Textured       |
|                         | <b>Color Option</b>                   |
|                         | <b>CC</b> Custom color                |

**Notes:**

- When ordering Energeni, specify the routine setting code (Example GENI-04). See Energeni brochure and instructions for setting table and options
- Not available with other wireless control or sensor options
- Specify group and zone at time of order. See [www.hubbell-automation.com/products/sitesync/](http://www.hubbell-automation.com/products/sitesync/) for further details. Order at least one SiteSync Interface accessory SWUSB or SWTAB. Each option contains SiteSync License, GUI, and Bridge Node

**Accessories**

- SWUSB**<sup>1</sup> SiteSync interface software loaded on USB flash drive for use with owner supplied PC (Windows based only). Includes SiteSync license, software and USB radio bridge node<sup>11</sup>
- SWTAB**<sup>1</sup> Windows tablet and SiteSync interface software. Includes tablet with preloaded software, SiteSync license and USB radio bridge node<sup>11</sup>
- SWBRG**<sup>1</sup> SiteSync USB radio bridge node only. Order if a replacement is required or if an extra bridge node is requested<sup>12</sup>

<sup>1</sup> When ordering with SiteSync, one of the following interface options must be chosen and ordered separately. Each option contains the SiteSync License, GUI and Bridge Node

+ If needed, an additional Bridge Node can be ordered

# SLIDE Series

ARCHITECTURAL AREA LUMINAIRE

## PERFORMANCE DATA

| # Of LEDs | Nominal Wattage | System Watts | Dist. Type | 5K (5000K NOMINAL 70 CRI) |      |   |   |   | 4K (4000K NOMINAL 70 CRI) |      |   |   |   | 3K (3000K NOMINAL 80 CRI) |      |   |   |   |
|-----------|-----------------|--------------|------------|---------------------------|------|---|---|---|---------------------------|------|---|---|---|---------------------------|------|---|---|---|
|           |                 |              |            | Lumens                    | LPW* | B | U | G | Lumens                    | LPW* | B | U | G | Lumens                    | LPW* | B | U | G |
| 24        | 350mA           | 27W          | 2          | 2715                      | 98   | 1 | 0 | 1 | 2798                      | 101  | 1 | 0 | 1 | 2475                      | 93   | 1 | 0 | 1 |
|           |                 |              | 3          | 2713                      | 98   | 1 | 0 | 1 | 2797                      | 101  | 1 | 0 | 1 | 2573                      | 93   | 1 | 0 | 1 |
|           |                 |              | 4          | 2748                      | 99   | 0 | 0 | 1 | 2833                      | 102  | 0 | 0 | 1 | 2606                      | 94   | 0 | 0 | 1 |
|           |                 |              | 4W         | 2584                      | 93   | 1 | 0 | 1 | 2664                      | 96   | 1 | 0 | 1 | 2451                      | 88   | 1 | 0 | 1 |
|           |                 |              | 5QM        | 2861                      | 103  | 2 | 0 | 0 | 2950                      | 106  | 2 | 0 | 0 | 2714                      | 98   | 2 | 0 | 0 |
|           |                 |              | 5R         | 2833                      | 102  | 2 | 0 | 2 | 2920                      | 105  | 2 | 0 | 2 | 2687                      | 97   | 2 | 0 | 2 |
|           |                 |              | 5W         | 2823                      | 102  | 2 | 0 | 1 | 2911                      | 105  | 2 | 0 | 1 | 2678                      | 97   | 2 | 0 | 1 |
| 24        | 700mA           | 55W          | 2          | 5031                      | 91   | 1 | 0 | 1 | 5187                      | 94   | 1 | 0 | 1 | 4772                      | 87   | 1 | 0 | 1 |
|           |                 |              | 3          | 5028                      | 91   | 1 | 0 | 2 | 5184                      | 94   | 1 | 0 | 2 | 4769                      | 87   | 1 | 0 | 2 |
|           |                 |              | 4          | 5093                      | 93   | 1 | 0 | 2 | 5250                      | 95   | 1 | 0 | 2 | 4831                      | 88   | 1 | 0 | 2 |
|           |                 |              | 4W         | 4788                      | 87   | 1 | 0 | 2 | 4936                      | 90   | 1 | 0 | 2 | 4542                      | 83   | 1 | 0 | 2 |
|           |                 |              | 5QM        | 5302                      | 96   | 2 | 0 | 1 | 5466                      | 99   | 3 | 0 | 1 | 5029                      | 91   | 2 | 0 | 1 |
|           |                 |              | 5R         | 5250                      | 95   | 3 | 0 | 3 | 5413                      | 98   | 3 | 0 | 3 | 4980                      | 91   | 3 | 0 | 3 |
|           |                 |              | 5W         | 5232                      | 95   | 3 | 0 | 1 | 5394                      | 98   | 3 | 0 | 1 | 4963                      | 90   | 3 | 0 | 1 |
| 36        | 700mA           | 80W          | 2          | 7547                      | 91   | 1 | 0 | 2 | 7780                      | 94   | 1 | 0 | 2 | 7158                      | 86   | 1 | 0 | 2 |
|           |                 |              | 3          | 7543                      | 91   | 1 | 0 | 2 | 7776                      | 94   | 1 | 0 | 2 | 7154                      | 86   | 1 | 0 | 2 |
|           |                 |              | 4          | 7640                      | 92   | 1 | 0 | 2 | 7876                      | 95   | 1 | 0 | 2 | 7246                      | 87   | 1 | 0 | 2 |
|           |                 |              | 4W         | 7183                      | 87   | 1 | 0 | 2 | 7405                      | 89   | 1 | 0 | 2 | 6812                      | 82   | 1 | 0 | 2 |
|           |                 |              | 5QM        | 7954                      | 96   | 3 | 0 | 1 | 8200                      | 99   | 3 | 0 | 1 | 7544                      | 91   | 3 | 0 | 1 |
|           |                 |              | 5R         | 7876                      | 95   | 3 | 0 | 3 | 8119                      | 98   | 3 | 0 | 3 | 7470                      | 90   | 3 | 0 | 3 |
|           |                 |              | 5W         | 7849                      | 95   | 3 | 0 | 2 | 8092                      | 97   | 3 | 0 | 2 | 7444                      | 90   | 3 | 0 | 2 |
| 48        | 700mA           | 110W         | 2          | 10062                     | 91   | 2 | 0 | 2 | 10373                     | 94   | 2 | 0 | 2 | 9543                      | 86   | 2 | 0 | 2 |
|           |                 |              | 3          | 10057                     | 91   | 1 | 0 | 2 | 10368                     | 94   | 1 | 0 | 2 | 9539                      | 86   | 1 | 0 | 2 |
|           |                 |              | 4          | 10186                     | 92   | 1 | 0 | 2 | 10501                     | 95   | 1 | 0 | 3 | 9661                      | 87   | 1 | 0 | 2 |
|           |                 |              | 4W         | 9577                      | 86   | 1 | 0 | 2 | 9873                      | 89   | 2 | 0 | 2 | 9083                      | 82   | 1 | 0 | 2 |
|           |                 |              | 5QM        | 10605                     | 96   | 3 | 0 | 2 | 10933                     | 99   | 3 | 0 | 2 | 10058                     | 91   | 3 | 0 | 2 |
|           |                 |              | 5R         | 10501                     | 95   | 3 | 0 | 3 | 10826                     | 98   | 3 | 0 | 3 | 9960                      | 90   | 3 | 0 | 3 |
|           |                 |              | 5W         | 10465                     | 94   | 4 | 0 | 2 | 10789                     | 97   | 4 | 0 | 2 | 9926                      | 90   | 4 | 0 | 2 |

1 Lumen values are from photometric tests performed in accordance with IESNA LM-79-08. Data is considered to be representative of the configurations shown. Actual performance may differ as a result of end-user environment and application

## DIMENSIONS

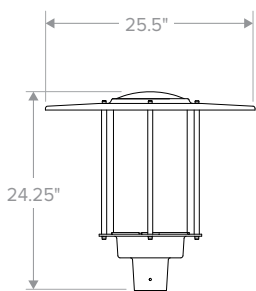

Flat Top/Flat Shade

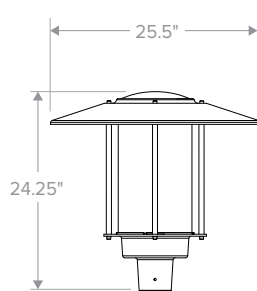

Flat Top/Curved Shape

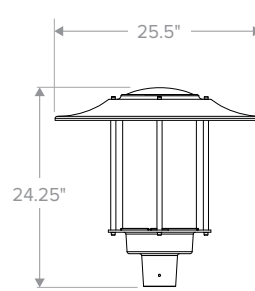

Flat Top/Sloped Shade

## USE OF TRADEMARKS AND TRADE NAMES

All product and company names, logos and product identifies are trademarks™ or registered trademarks® of Hubbell Lighting, Inc. or their respective owners. Use of them does not necessarily imply any affiliation with or endorsement by such respective owners.